

# devola

Comfortable living everyday

## Instruction Manual

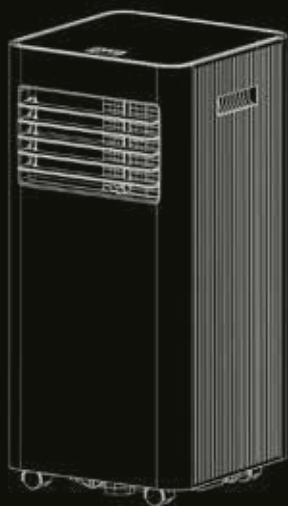

# Devola Portable Air Conditioner

DVAC09CB, DVAC09CW,  
DVAC10CW, DVAC10CHW



[devola.co.uk](http://devola.co.uk)

### PRODUCT DESCRIPTION

Our powerful portable air conditioners are great cooling solutions for single rooms, creating a comfortable atmosphere in your space. They also have ventilation, heating (model dependent) and dehumidifying functions for effectively circulating air and the removal of excess moisture. They are self-contained systems allowing you to move the unit to the space in which it is most needed.

The environmentally friendly R290 is used as the refrigerant in the air conditioner. R290 has no damaging influence on the ozone layer (ODP), a negligible greenhouse effect (GWP) and is available worldwide. Due to its efficient energy properties, R290 is highly suitable as a coolant for this application, however, special precautions must be taken into consideration due to the coolant's high flammability.



**WARNING**

**Please read this manual carefully and fully understand the instructions before operating your appliance.**

## SYMBOLS FROM THE UNIT AND USER MANUAL



**warning**

This unit contains a flammable refrigerant.

If the refrigerant leaks and comes in contact with fire or other heating part, it will create harmful gas and there is risk of fire.



Read the INSTRUCTION MANUAL carefully before operation.



Further information is available in the INSTRUCTION MANUAL, and the like.



Service personnel are required to carefully read the INSTRUCTION MANUAL before operation.



Failure to comply with these safety instructions could result in fire, damage to property, serious injury or potentially death.

## **THE FOLLOWING SHOULD ALWAYS BE OBSERVED FOR SAFETY**



- The unit is designed only for use with R290(propane) gas as the designated refrigerant.
- The refrigerant loop is sealed. Only a qualified technician should attempt to service!
- Do not discharge the refrigerant into the atmosphere.
- R-290 (propane) is flammable and heavier than air.
- If propane gas is present or even suspected, do not allow untrained personnel to attempt to find the cause.
- The propane gas used in the unit has no odor.
- The lack of smell does not indicate a lack of escaped gas.
- If a leak is detected, immediately evacuate all persons from the space, ventilate the room and contact the local fire department to advise them that a propane leak has occurred.
- Do not let any persons back into the room until the qualified service technician has arrived, and that technician advises that it is safe to return to the room.
- No open flames, cigarettes or other possible sources of ignition should be used in the vicinity of the unit.
- Component parts are designed for propane and non-incentive and non-sparking. Component parts shall only be replaced with identical repair parts.

## **OPERATIONAL PRECAUTIONS**

### **WARNING - to reduce the risk of fire, electric shock or injury to persons or property:**

- If the supply cord is damaged, it must be replaced by the service agent or similarly qualified persons to avoid a hazard.
- Always operate the unit from a power source of equal voltage, frequency and rating as indicated on the rating label.
- Always use a power outlet that is grounded.
- Unplug the power cord when cleaning or when not in use.
- Do not operate with wet hands. Prevent water from spilling onto the unit.
- Do not immerse or expose the unit to rain or any other liquid.
- Do not leave the unit running unattended. Do not tilt or turn over the unit.
- Do not unplug while the unit is operating.
- Do not unplug by pulling on the power cord.
- Do not use an extension cord or an adapter plug.
- Do not put objects on the unit.
- Do not climb or sit on the unit.
- Do not insert fingers or other objects into the air outlet.
- Do not touch the air inlet or the aluminum fins of the unit.
- Do not operate the unit if it is dropped, damaged or showing signs of product malfunction.
- Do not clean the appliance with any chemicals.
- Ensure the unit is far away from fire, inflammable, or explosive objects.

- Do not use means to accelerate the defrosting process or to clean, other than those recommended by the manufacture.
- The appliance should be stored in a room free from continuously operation sources (for example: open flames, an operating gas appliance or an operating electric heater).
- The appliance shall be adequately stored to prevent mechanical damage from occurring.
- Be aware that refrigerants may not contain an odour.
- Compliance with national gas regulations shall be observed.
- Keep any required ventilation openings clear of obstruction.
- The appliance shall be stored in a well-ventilated area where the room size corresponds to the room area as specified for operation.

 <b>WARNING</b>	<p>Any individual that operates or works on the refrigerant circuit should hold valid certification from an industry-accredited assessment authority, which authorizes their competence to handle the R290 refrigerant safely in accordance with an industry, recognized assessment specification.</p>
 <b>WARNING</b>	<p>Servicing shall only be performed as recommended by the equipment manufacturer. Maintenance and repair requiring the assistance of other skilled personnel shall be carried out under the supervision of a person(s) competent in the use of flammable refrigerants.</p>

## PRODUCT IDENTIFICATION

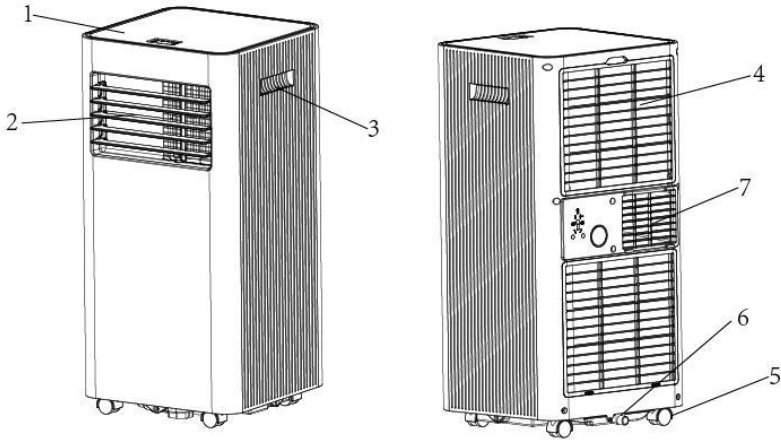

1. Control Panel
2. Air Outlet with Manual Horizontal and Vertical Adjustable Louver
3. Handle
4. Air Inlet with Air Filter
5. Castor
6. Drainage Opening
7. Air Exhaust

---

Note: The unit in the above diagram is for reference only and may differ slightly from the model purchased.

---

## PRODUCT FEATURES

- ✓ Compact unit with High Output Capacity
- ✓ Cooling, Heating (DVAC10CHW model only), Dehumidifying and Fan Functions
- ✓ Wi-Fi Enabled
- ✓ Compatible with Alexa and Google Home Devices
- ✓ 1.8m Exhaust Hose
- ✓ 2 Window Kits
- ✓ Horizontal and Vertical Manual Louver Oscillation
- ✓ Temperature Setting and Display
- ✓ Digital LED display
- ✓ Electronic Control with built-in Start-Up and Shutdown Timer
- ✓ Sleep mode
- ✓ Self-evaporating System for improved Efficiency
- ✓ Full Tank Automatic Shutdown
- ✓ Automatic Restart in the event of Power Outage
- ✓ Auto Defrosting Function at low Ambient Temperatures
- ✓ Remote Control
- ✓ 2 Speed Fan
- ✓ Castors and Handle for easy Mobility



## UNPACKING

Unpack the carton taking the appliance and all accessories out. Please check that no parts are missing before installation.

### Accessories:

- Ducting Hose (1.8m)
- Duct Hose Connector
- Duct Window Kit Adapter
- Remote Control
- Window Kit Plate
- Drainage pipe
- Window curtain

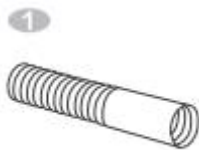

6.



7.



## PRE-SET UP ADVICE

- If tipped more than 45°, allow the unit to sit upright for at least 8 hours before operation.
- Place the unit on a firm, level surface in an area with at least 50cm of free space around it to allow for adequate air circulation.
- Do not operate in proximity to walls, curtains, or other objects that may block air inlet and outlet.
- **Never** install the unit where it could be subject to the following:
  - Heat sources such as radiators, stoves or other products that produce heat.
  - Direct sunlight
  - Mechanical vibration or shock
  - Excessive dust
  - Lack of ventilation
  - Uneven surface

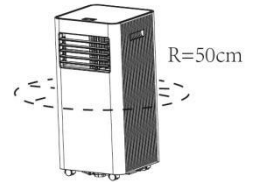



## **WARNING!**

Install the unit in rooms which exceed 10m<sup>2</sup>.

Do not install the unit in a place where inflammable gas may leak.

## **INSTALLING THE WINDOW KIT**

The portable air conditioner must be vented outside to remove the hot air. There are two types of window kit provided. Only one type of kit is required and will depend on the window or door being used. We recommend window kit plates on sliding doors and windows and the flexible window kit for all other types.

Do not attempt to replace or extend the ducting hose, the 1.8m hose provided is compatible with our models.

**Step 1: Connect the duct hose connector to one end of the ducting hose.**

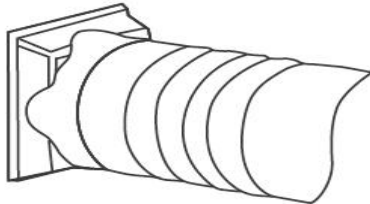

**Step 2: Connect the window kit adapter to the other end of the ducting hose.**

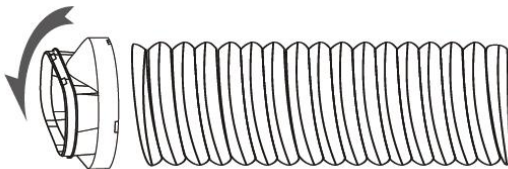

**Step 3: Connect the exhaust hose to the window kit via the window kit adapter. Extend the adjustable window kit the length of your window.**



**Step 4: Close the window to secure the kit in place. It needs to hold the window kit firmly in place (secure the window kit with duct tape if required). It is recommended that the gap between the adapter and the sides of the window should be sealed off for maximum efficiency.**

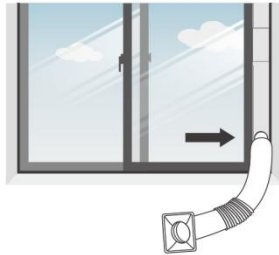

**Step 5: Attach the ducting hose to the air exhaust on the unit using the hose connector.**

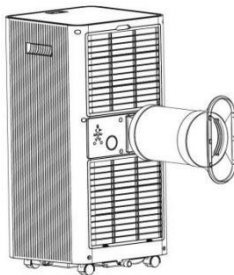

**Step 6: Adjust the length of the ducting hose ensuring there aren't any kinks or bends. Then place AC near an electrical outlet.**

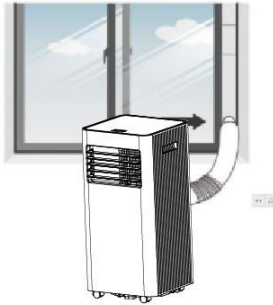

**Step 7: Adjust the louver at the air outlet and switch on the unit. The louvers can be manually adjusted to control the air flow horizontally and vertically.**

### **FLEXIBLE WINDOW KIT INSTALLATION**

1. Mark the middle (M) of the window seal (Fig.1)
2. Mark the middle of the window frame and the casement (Fig.2-4) (Figure2 shows an open window, Figure 3 a tilted window and Figure 4 an open skylight).
3. Stick the Velcro tape to the front side (in most cases 1 cm wide) of the casement or to the inner surface of the casement (where the window handle is attached).
4. First fasten side A, then side B, starting in the middle and working all the way to the left and right.
5. IMPORTANT! During fastening, point A must be exactly opposite point B.
6. When closing the window take care that the seal is not jammed between the casement and window frame.
7. Open the zip preferably at the positions marked with "S" and attach the ducting hose.

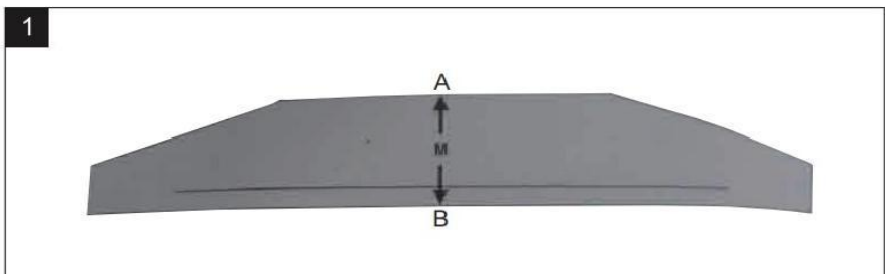

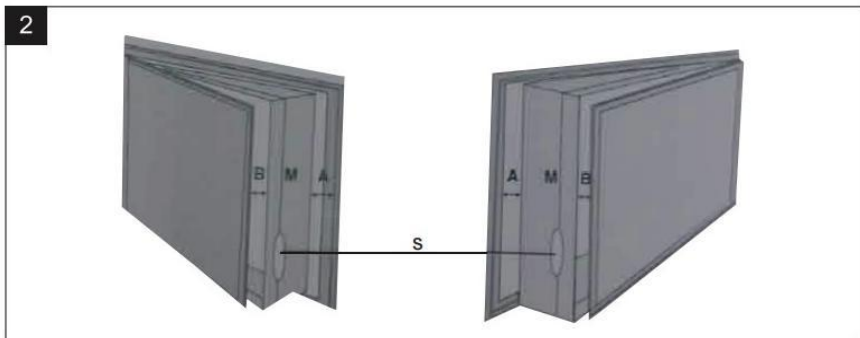
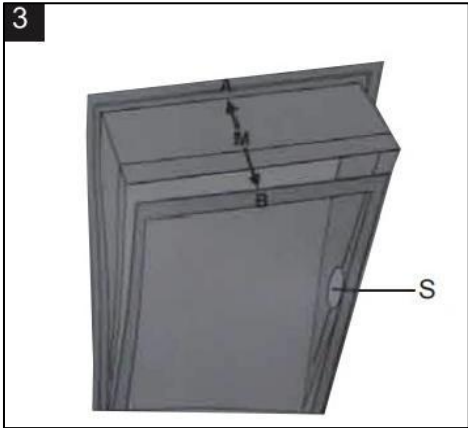

## CONTROL PANEL AND DISPLAY

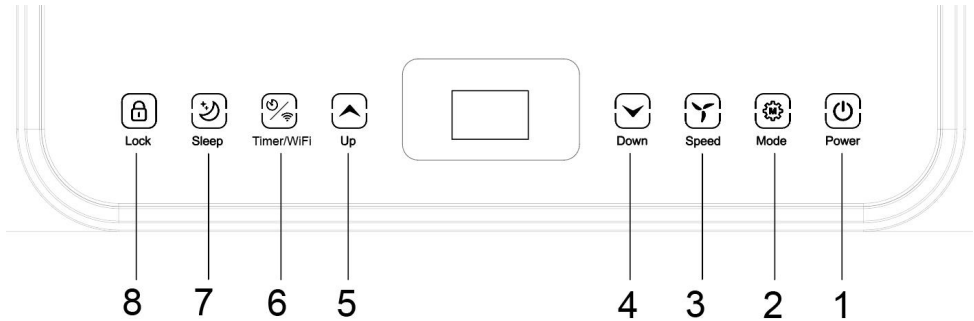

<b>1</b>	<b>POWER</b>	Press to switch the machine on or off.
<b>2</b>	<b>MODE</b>	Press to switch between the operating modes: fan, cooling, heating (where applicable) and dehumidifier.
<b>3</b>	<b>SPEED</b>	Press to switch between the Low and High fan speeds.
<b>4</b>	<b>DOWN</b>	Decrease the desired temperature or timer setting.
<b>5</b>	<b>UP</b>	Increase the desired temperature (16°C ~ 32°C) or timer setting.
<b>6</b>	<b>TIMER/WIFI</b>	Set a time for the unit to automatically start or stop. Long press this key to activate the wifi function.
<b>7</b>	<b>SLEEP</b>	Press to activate or disable the sleep mode.
<b>8</b>	<b>LOCK</b>	Press to activate or disable the child lock function

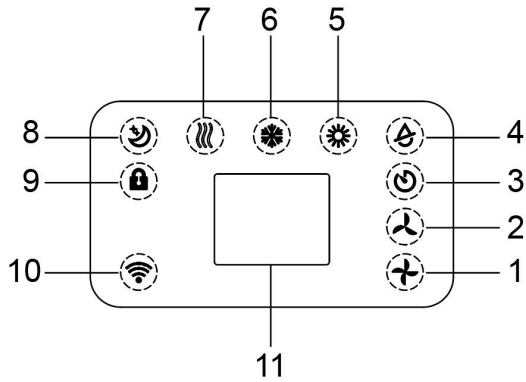

1. High Fan Speed
2. Low Fan Speed
3. Timer
4. Dehumidifier Mode
5. Heating Mode
6. Cooling Mode
7. Fan Mode
8. Sleep Mode
9. Child Lock
10. Wi-Fi
11. Display Window



## REMOTE CONTROL

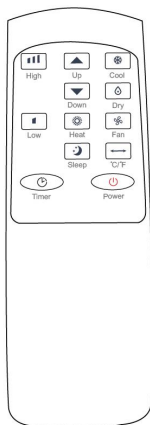

1. High	Press to switch the machine on to high fan mode
2. Low	Press to switch the machine on to low fan mode
3. Timer	Press to set a time for the unit to automatically start or stop within 24 hours
4. Up	Press to increase the desired temperature or timer setting
5. Down	Press to decrease the desired temperature or timer setting
6. Sleep	Press to turn sleep mode on or off. The sleep mode only works when the unit is in cooling mode
7. Heat	Press to put machine onto heat mode
8. Cool	Press to turn the machine onto cooling mode
9. Dry	Press to put the machine on dehumidifying mode
10. Fan	Press to turn the machine onto fan only mode
11. Unit	Press to switch between °C and °F
12. Power	Press to turn the unit on and off

## SETTINGS

### Start-up and Shutdown

Press the POWER button to turn the unit on (when the unit begins operating it runs on the fan mode as default).

Press the POWER button again to turn off the unit.

### Operating Modes

The unit has five operating modes: Cool, Dry, Fan, Heat (for heating model only), Sleep. The various modes can be selected using the control panel or the remote control.

#### Cooling Mode

1. Press the MODE button repeatedly until the LED icon for COOL illuminates.
2. Select the cool mode to lower the temperature in your room.
3. Press the Up/Down button to adjust the temperature which is displayed on the screen. The temperature can be set between 16°C and 32°C.
4. Press the SPEED button repeatedly until the desired fan speed indicator lights up.
5. To control the direction of the air flow, please adjust the inner louver by hand.

Note: The air conditioner stops if the room temperature is lower than selected temperature.

#### Heat Mode (applicable for heating models only)

1. Press the MODE button repeatedly until the LED HEAT icon illuminates.
2. Press the Up/Down button to set the temperature higher than the current room temperature. The fan speed can also be set in this mode.

Note: The drainage hose should be attached to the unit for continuous operating.

#### Fan/Ventilation Mode

1. Press the MODE button repeatedly until the LED FAN icon illuminates.
2. In ventilation mode the room air is circulated, but not cooled.
3. Press the SPEED button repeatedly to select the fan speed as desired.

## **Drying Mode**

Press the MODE button repeatedly until the LED DRY icon illuminates. The fan speed cannot be changed in this mode.

When using the drying mode, the user should connect the drainage hose to the drain outlet at the bottom of the unit.

Note: In this mode, the low fan speed is set as default and cannot be changed.

## **Sleep mode (this function can only be used with a remote control)**

The sleep mode can only be activated when the cool or heat mode is in use.

### **In cool mode:**

After 1 hour the preset temperature is increased by 1 °C, after another hour the preset temperature will again be increased by 1 °C.

### **In heat mode (applicable for heating models only):**

After 1 hour the preset temperature is decreased by 1 °C, after another hour the preset temperature will again be decreased by 1 °C.

Then the temperature is kept constant for 10 hours. And all the indicators dim to dark. The fan speed may switch over to low speed for silent operating and cannot be selected.

## TIMER FUNCTION

The timer function can be set between 1-24 hours, in hourly increments.

The timer has two modes of operation:

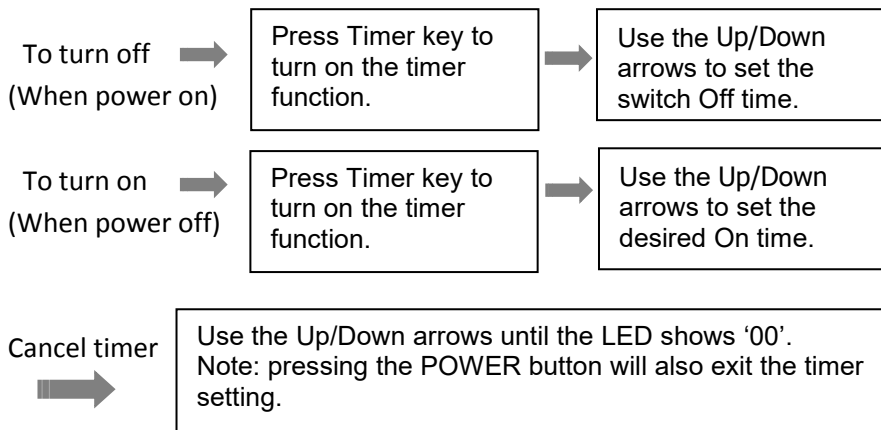

## Automatic Defrost Function

At low room temperatures, frost may build up at the evaporator during operation. The unit will automatically start defrosting and the **POWER** LED light will flash.

When the unit operates in Cool or Drying mode and the ambient temperature sensor detects that the evaporator coil temperature is below  $-1^{\circ}\text{C}$ , the compressor will stop operating for ten minutes or until the temperature has reached  $7^{\circ}\text{C}$ . The AC will then restart in Cool mode.

## Overload Protection

In the event of a power cut, to protect the compressor there is a 3-minute delay until the compressor restarts operation when the power is regained. As the air conditioner has a memory function, it will operate as per the settings before the power cut occurred.

## 9. WIFI CONNECTION

### How to connect to your mobile phone

This appliance allows you to operate the appliance via your home network. A prerequisite is a permanent WIFI connection to your router and the free app “Smart Life”.

The “Smart Life” app is available for android and iOS.

Scan the below QR code to download the app.



#### Commissioning via the App

1. Install the Smart Life app and create a user account.
2. Activate the Wi-Fi function in the settings of your appliance.
3. Place the appliance at a distance of around 5 meters from your router.
4. When the power is turned on the wi-fi indicator will flash slowly to indicate the air conditioner is in pairing mode. If the unit is not connected to the app within 3 minutes the wi-fi indicator will stop flashing. Hold the timer button for 5 seconds to re-enable the pairing mode.
5. When Wi-Fi indicator flashes, select “Add Device”> “Large Home Appliances”> “Air Conditioner”, and follow the instructions on the display. Select “AP Mode” on upper right hand corner of the screen, choose “Confirm indicator slowly blink” and press “Go to Connect” to connect the Wi-Fi named “SmartLife-XXXX” .
6. Once the appliance has been successfully connected, the Wi-Fi icon will illuminate. Now you can operate the appliance using the app.
7. To disconnect the appliance from the app press and hold the Timer button for about 5 seconds and the Wi-Fi icon will switch off.

<b>TROUBLE SHOOTING</b>	
Network connection failed	Solution
Network connection timeout	<ol style="list-style-type: none"> <li>1. Check if you have selected the Wi-Fi named “SmartLife-XXXX” .</li> <li>2. Turn off the machine and unplug it from the power source. Wait 10 seconds before plugging the unit back in, then follow the connectivity instructions.</li> </ol>
Wi-Fi indicator has switched off	<ol style="list-style-type: none"> <li>1. Hold the timer button for 5 seconds to re-enable the pairing mode.</li> <li>2. Turn off the machine and unplug it from the power source. Wait 10 seconds before plugging the unit back in, then follow the connectivity instructions.</li> </ol>
Wi-Fi hotspot has disappeared and the Wi-Fi light is flashing	<ol style="list-style-type: none"> <li>1. Turn off the machine and unplug it from the power source. Wait 10 seconds before plugging the unit back in, then follow the connectivity instructions.</li> </ol>

# How to connect to your Alexa devices

- Type 'Smart Life' in the search bar and click the option with the  icon

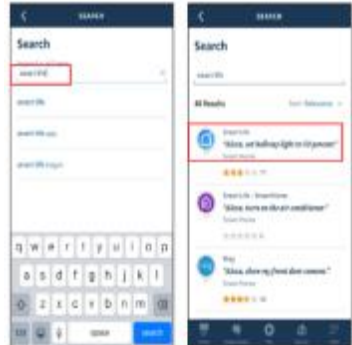

- Click 'Enable to use and type your phone number/ email address and password and click 'Link Now'

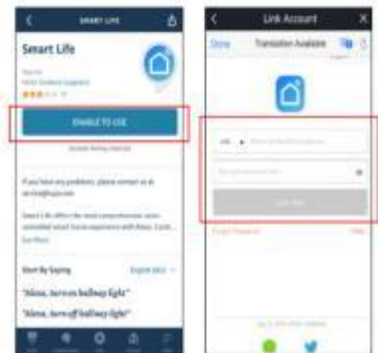

- Click 'Authorise' and go back to the home screen. Your devices will now appear, and you can operate using voice control.

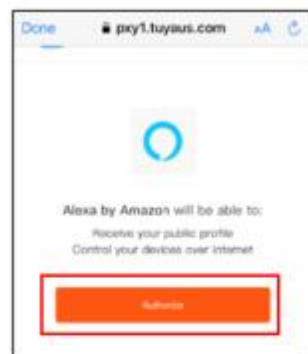

# How to connect to your Google Home devices

Follow the below instructions to connect your device to Google Home.

- Download the Google Home App and pair your device.

**Note: change the name of the device to an easily identifiable name such as 'Air Conditioner'.**

**Note: Ensure you have downloaded and have configured the Google Home/Assistant apps. Please see your Google device's user manual for instructions.**

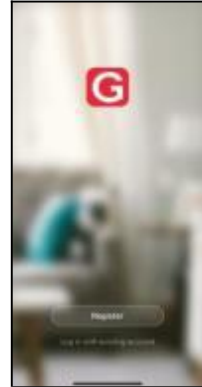

- On the main page of the Google Home app, click the '+' icon in the top left-hand side of the page.

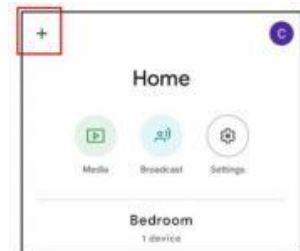

- Click 'Set up device'

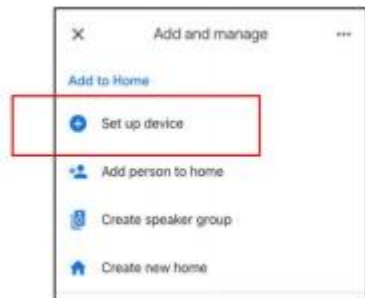



# How to connect to your Google Home devices

- Click 'Works with Google'



- Type 'Smart Life' in the search bar and click the option with the  icon



- Enter your phone number/ email address and password and click 'Link Now'



# How to connect to your Google Home devices

- Click 'Authorise' and all devices from your Google Home App will appear on screen. You then have the option to add these to a particular room in your home. When you go back to the home screen, your devices will now appear, and you can operate the unit using voice control.

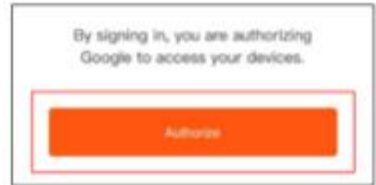

## DRAINAGE

### Self- evaporating system

There is usually no need to empty the drainage tank in cooling mode, as the self-evaporating system uses the collected water to cool the condenser coils and the excess water is evaporated and released through the exhaust hose. The drainage tank will usually fill up when used in heating mode (DVAC10CHW model only) or in dehumidifying mode. If you need to empty the drainage tank on a regular basis during cooling mode then this could be due to usage in a room with either high humidity conditions or the air conditioning unit is being used in a room too big for its cooling capacity.

For continuous operation or unattended operation during drying or heating, please connect the drainage hose to the unit. The water can then automatically flow into a bucket or drain.

- Switch off the unit before operating.
- Remove the plug and keep it safe.
- Securely connect the drain hose ensuring it is not kinked and clear of obstruction.
- Place the outlet hose over a drain or bucket and ensure that water can freely flow out of the unit.
- Do not submerge the end of hose into water; otherwise, it can cause "Air Lock" in the hose.

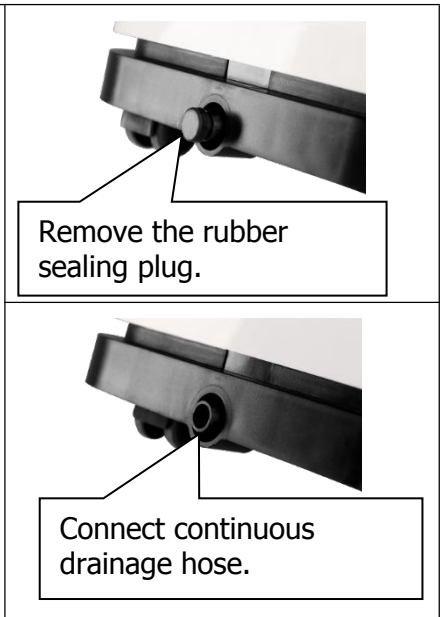

**To avoid water spillage:**

- As the negative pressure of condensate drain pan is large, tilt the drain hose downward toward the floor. It is appropriate that the degree of inclination should exceed 20 degrees.
- Straighten the hose to avoid a trap existing in the hose.

**CLEANING AND CARE****CLEANING THE AIR FILTER**

Dust collects on the filter and restricts the airflow. The restricted airflow reduces the efficiency of the system and if it becomes blocked it can cause damage to the unit.

The air filter requires regular cleaning (every two weeks). The air filter is removable for easy cleaning. Do not operate the unit without an air filter, or the evaporator may be contaminated.

1. Press the POWER button to switch off the unit and unplug the power cord.
2. Remove the mesh filter from the unit.
3. Use a vacuum cleaner to remove the excess dust from the filter.
4. Turn the filter over and rinse the air filter under running water. Let the water run through the filter in the opposite direction of air flow. Set aside and allow the filter to air dry completely before reinstalling.

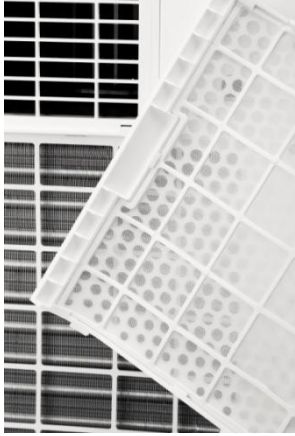

Pic1. Switch off the unit and remove the air filter.

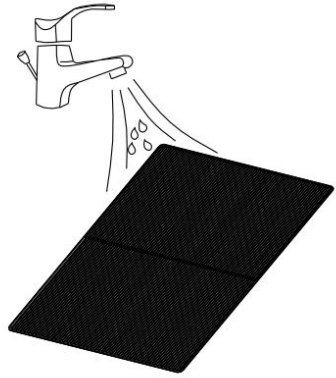

Pic2. Rinse the air filter under running water.

**Warning!!!**

Do not touch the evaporator surface with your bare-hand, or it could cause injury of your fingers.

## CLEANING UP OF REFRIGERANT

### General Measures:

- Gas/vapor is heavier than air. It may accumulate in confined spaces, particularly at or below ground level.
- Eliminate every possible source of ignition.
- Use appropriate personal protection equipment (PPE).
- Evacuate unnecessary personnel, isolate, and ventilate area.
- Avoid contact with eyes, skin, or clothing.
- Do not inhale vapors or gas.
- Prevent entry to sewers and public waters.
- Stop the source of the release, if safe to do so. Consider the use of water

spray to disperse vapors.

- Isolate the area until gas has dispersed. Ventilate and gas test area before entering. Contact competent authorities after a spill.

## TROUBLESHOOTING

Symptom		Inspection	Solution
The unit is not operating.		✓ Check the power connection.	➤ Insert the power cord and check the power outlet.
		✓ Check if the water level indicator is illuminated.	➤ Empty the tank by removing the rubber plug.
		✓ Check the room temperature.	➤ The range of operating temperature is 5-35°C.
The unit works with reduced capacity.		✓ Check the air filter for dirt.	➤ Clean the air filter as necessary.
		✓ Check if the air duct is blocked.	➤ Clear the obstacle.
		✓ Check if the room door or window is open.	➤ Close any doors or windows.
		✓ Check if the desired operating mode is selected and the temperature is properly set.	➤ Set the mode and temperature at proper set-point according to the manual
		✓ The exhaust hose is detached.	➤ Make sure the exhaust hose is securely attached.
Water Leakage		✓ Overflow while moving the unit.	➤ Empty the water tank before transportation.
		✓ Check if the drain hose is kinked or bends.	➤ Straighten the hose to avoid a kink/bend.
Excessive Noise		✓ Check if the unit is securely positioned.	➤ Place the unit on horizontal and firm ground.
		✓ Check if any loose, vibrating parts.	➤ Secure and tighten loose parts.
		✓ Noise sounds like water flowing.	➤ Noise comes from flowing refrigerant. This is normal.
Error Codes	E0	✓ Communication faults between main PCB and display PCB.	➤ Check the wire harness of the display PCB for damage.
	E1	✓ Ambient temperature sensor failure	➤ Check connection or replace it. Clean or replace the temperature sensor.
	E2	✓ Coil temperature sensor failures.	➤ Check connection or replace it. Clean or replace the temperature sensor.
	Ft	✓ Condensate water high level alarm.	➤ Empty the tank by removing the rubber plug.

**STORAGE**

Long-Term Storage - If you will not be using the unit for an extended period (more than a few weeks), it is best to clean the unit and dry it out completely. Please store the unit per the following steps:

1. Unplug the unit, remove the exhaust hose and window kit, to store with the unit.
2. Drain the remaining water from the unit.
3. Clean the filter and let the filter dry completely in a shaded area.
4. Re-install the filter.
5. The unit must be kept in an upright position during storage.
6. Preserving the machine in a ventilated and dry safe indoor place, free from non- corrosive gas.

**ATTENTION:**

The evaporator has to be dried out before the unit is packed, to avoid component damage or mould. Unplug the unit and place it in a dry open area for a few days to dry it out. Another way to dry out the conditioner is to set it to the low-wind ventilation mode and maintain this state until the drainage pipe becomes dry.

**DISPOSAL**



**WARNING!!!**

Releasing refrigerant into atmosphere is strictly forbidden!

Do not dispose of electrical appliances as unsorted municipal waste, use separate collection facilities. Contact your local government for information regarding the collection systems available. If electrical appliances are disposed of in landfills or dumps, hazardous substances can leak into the groundwater and get into the food chain, damaging your health and well-being.

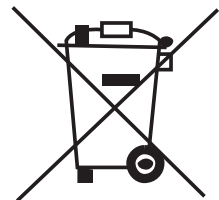









## Product Registration

Register your warranty online  
within 30 days of purchase.

[www.devola.co.uk/warranty](http://www.devola.co.uk/warranty)

## Scan for technical details



DVAC09CB



DVAC09CW



DVAC10CW



DVAC10CHW



[devola.co.uk](http://devola.co.uk)

Unit 1, Reedswood Park Road, Walsall, West Midlands. WS2 8DQ

Helpline 0800 043 4243 Email [info@devola.co.uk](mailto:info@devola.co.uk)